

**Construction:**

The unit consists of a supporting structure (1) which holds a bracket (2). A settling ring (3) is tightened with bolts to the brackets. An igniter (9), reflector ODB-2 (6) and ceramic lampholder (5) is mounted on the ring. A bulb (7) is fitted into the lampholder. A shade (8) is placed between the frame and the ring. The ring is sealed with a gasket (10). The luminary is closed with a PCV cover (11) with a polycarbonate stack (12) and aluminium finial (13).

**Mounting instructions:**

- Open the luminary cover (11) and lift the frame (3)
- Make the electrical connections with the igniter (9)
- Screw in the source of light (7) to the lampholder (5)
- Close the frame and the cover (11), secure it with bolts.
- Carry the wires inside the luminary.
- Place the luminary on the pole.
- Screw in the luminary supporting structure (1) with the pole.

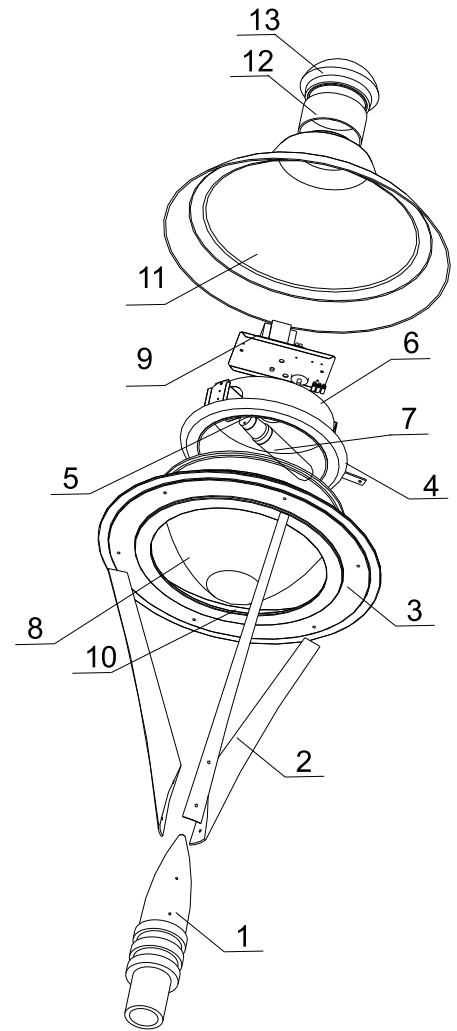

**TECHNICAL DATA:**

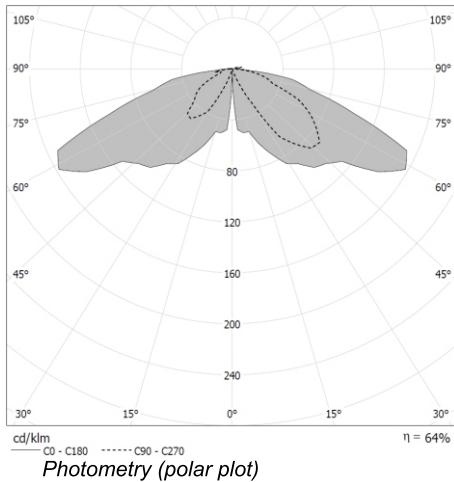

**Power: ~230/50Hz**

**Protective class: I** 

**IP66 -electrical part**

**IP66 -optical part**

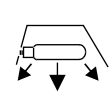
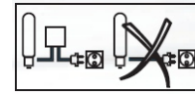
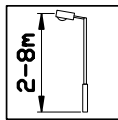

**ELECTRICAL DIAGRAM:**

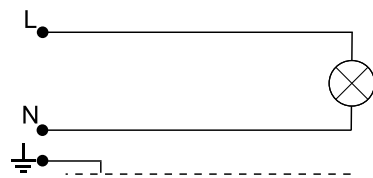

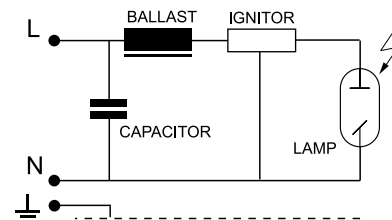

1. Incandescent bulb

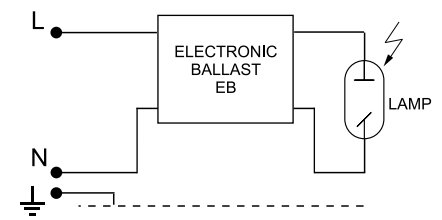

2. Sodium / metal halide lamps

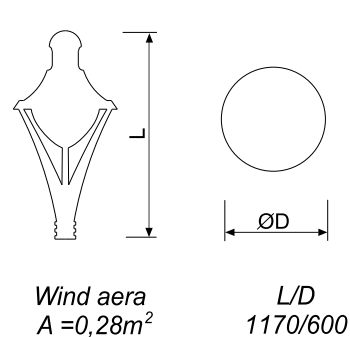

3. Sodium / metal halide lamps

Type	Light-producing element	Lamp holder	Weight [kg]	Pn [W]		Luminary dimensions
				IC	EB	
10MH-70W	MH/HSI/HPI	E27	14,2	81	78	 <p>Wind area A = 0,28m<sup>2</sup></p> <p>L/D 1170/600</p> 
10MH-100W	MH/HSI/HPI	E27	14,3	114	109	
10MH-150W	MH/HSI/HPI	E27	15,0	169	164	
10S-70W	WLS/SHP/SON	E27	14,2	81	78	
10S-100W	WLS/SHP/SON	E40	14,4	114	109	
10S-150W	WLS/SHP/SON	E40	15,1	169	164	
10Z-E/Z	Bulb / MINI - LINX	E27	12,9	Max. 60		

**WARNING !!** The weight of the unit may slightly differ for individual production batches.